

# Safe and Secure Schools by Design

EdSpaces

Wednesday, November 8  
8:00 AM

Jason Russell  
President & Founder, SEC

Ron Boezwinkle  
K-12 Client Lead & Architect, GMB



# Introduction

---



**Jason Russell**

**President**

[jason.russell@secureed.com](mailto:jason.russell@secureed.com)



**Ron Boezwinkle**

**K-12 Client Lead**

[ronb@gmb.com](mailto:ronb@gmb.com)







# Who is SEC?

---

Since 2013, SEC has developed comprehensive, prevention-focused safety & security programs for organizations across the country. Our roots began in the childcare industry and has expanded to partner with thousands of schools, churches and workplaces in the U.S.

## **Suite of Services:**

- Site Assessments
- Training Programs
- Security Design Consulting
- Emergency Response Planning
- Incident Management
- Targeted Social Media Monitoring
- Crisis Management
- SHIELD Security Personnel & Training Programs



# Who is GMB?

---

At GMB we are driven by the idea that continual learning provides transformational opportunities for our communities, industries, and our world. We believe that by investing in our future and creating learning ecosystems, we can provide opportunity for all.

## Fast Facts:

- 55 Years in K-12 and Higher Education
- 3000+ K-12 Projects
- Over \$5.95B in K-12 Work
- Team of Teams
- Expertise in:
  - Architecture + Engineering
  - Interior Design
  - Long Range Planning + Community Engagement
  - Educational Space Planning

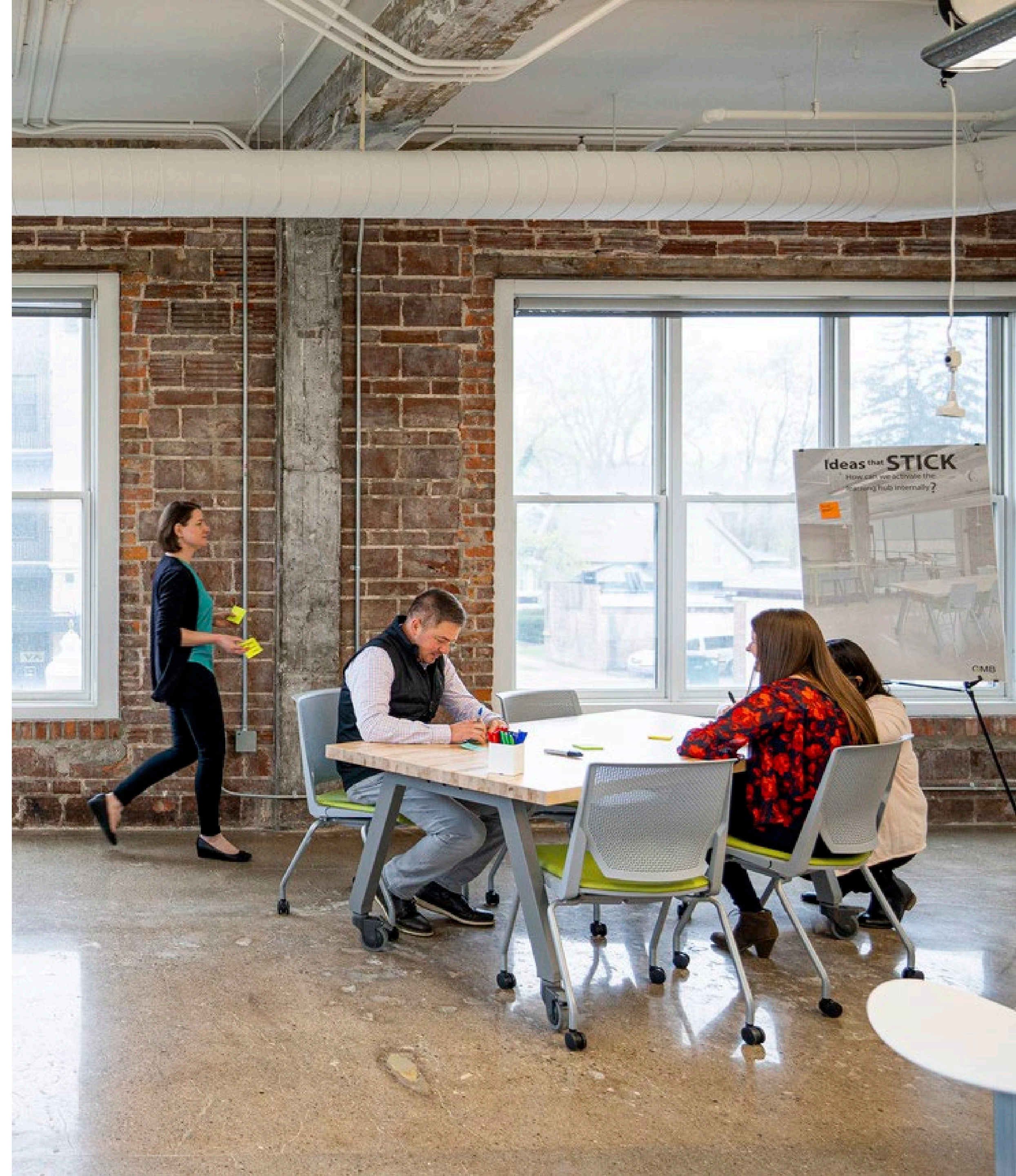

# Outline:

---

- Getting to Know You
- Why Safety in Design
- Site Assessments
- Design Approach
- Takeaways

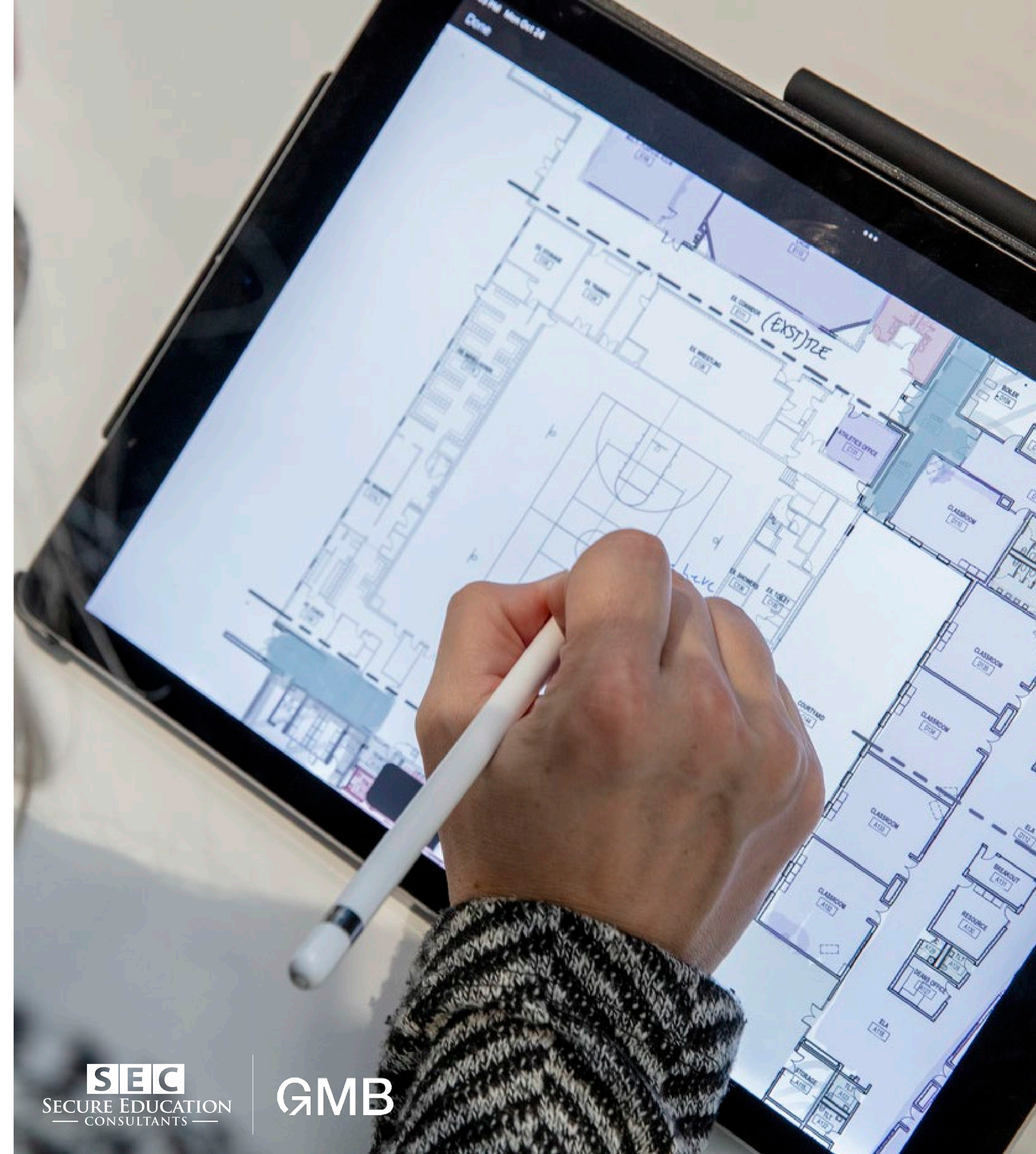

# Getting to Know You

---

Go to  
**[www.menti.com](https://www.menti.com)**

Enter the code  
**4512 2568**



Or use the QR code

Join at [mentimeter.com](https://mentimeter.com) use code **6729 4487**

 **Mentimeter**

 **Account**



Content



Design



Settings

# What school district or firm are you from? (State included)

Getting to know YOU



Help &  
Feedback

Join at [mentimeter.com](https://mentimeter.com) use code **6729 4487**

 **Mentimeter**

  
Account

  
Content

  
Design

  
Settings

# What is your role?

Waiting for responses ...

  
Help &  
Feedback



Join at [mentimeter.com](https://mentimeter.com) use code **6729 4487**

 **Mentimeter**

 **Account**

 **Content**

 **Design**

 **Settings**

# What is your name and email address?

Getting to know YOU

Results are hidden

 **Help & Feedback**

Join at [menti.com](https://menti.com) use code 6562 926

 Mentimeter

# When was the last time you completed a security assessment?



Join at [menti.com](https://menti.com) use code 6562 926

 Mentimeter

# What are your concerns regarding school safety?

Waiting for responses ...





# Why Safety in Design?

---





# School Safety History

---

In 2018, the Federal School Safety Commission issued a report on school safety.

**7 topics that have a direct affect on safety:**

- Character development and connectedness
- Cyberbullying
- Mental health and counseling
- Anonymous reporting systems and threat assessments
- School personnel training
- School building security
- Active shooter preparedness

# School Shooting Incidents

By Year

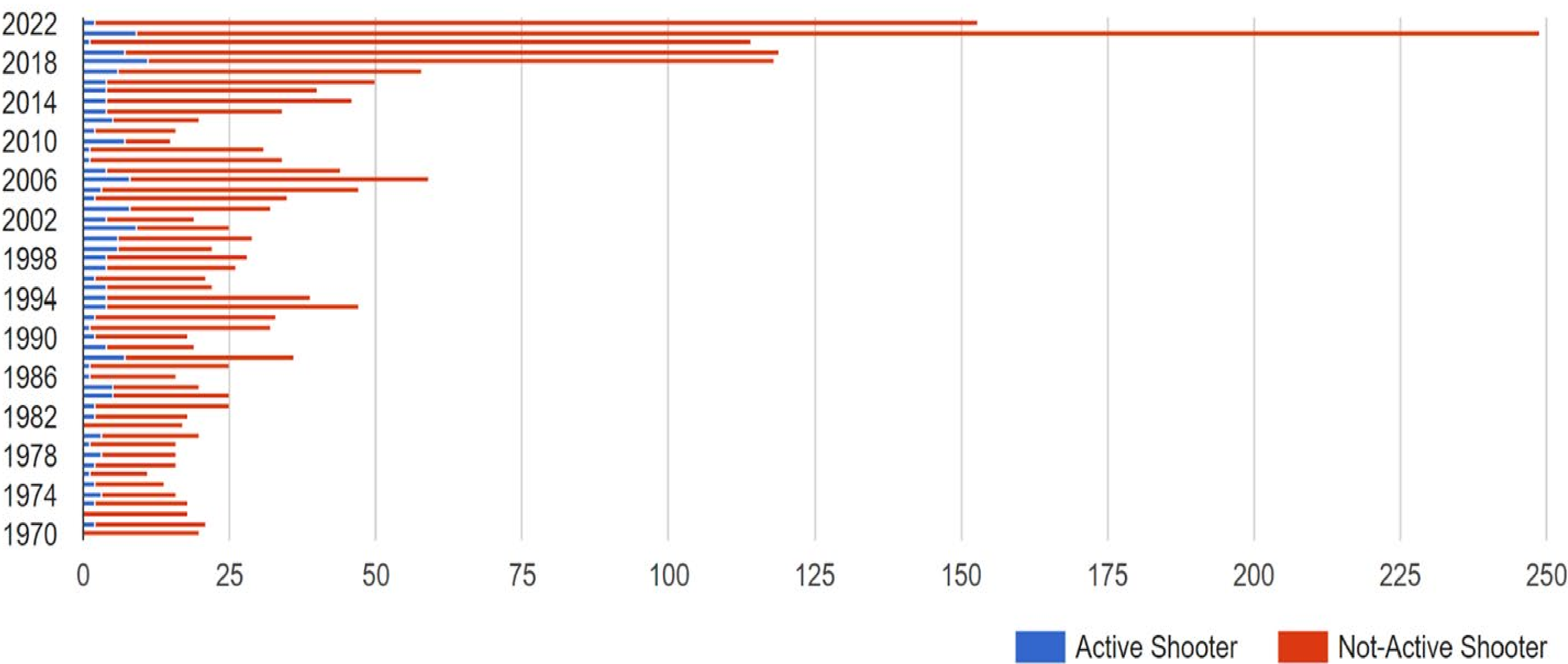



# School Shooting Incidents

By Location

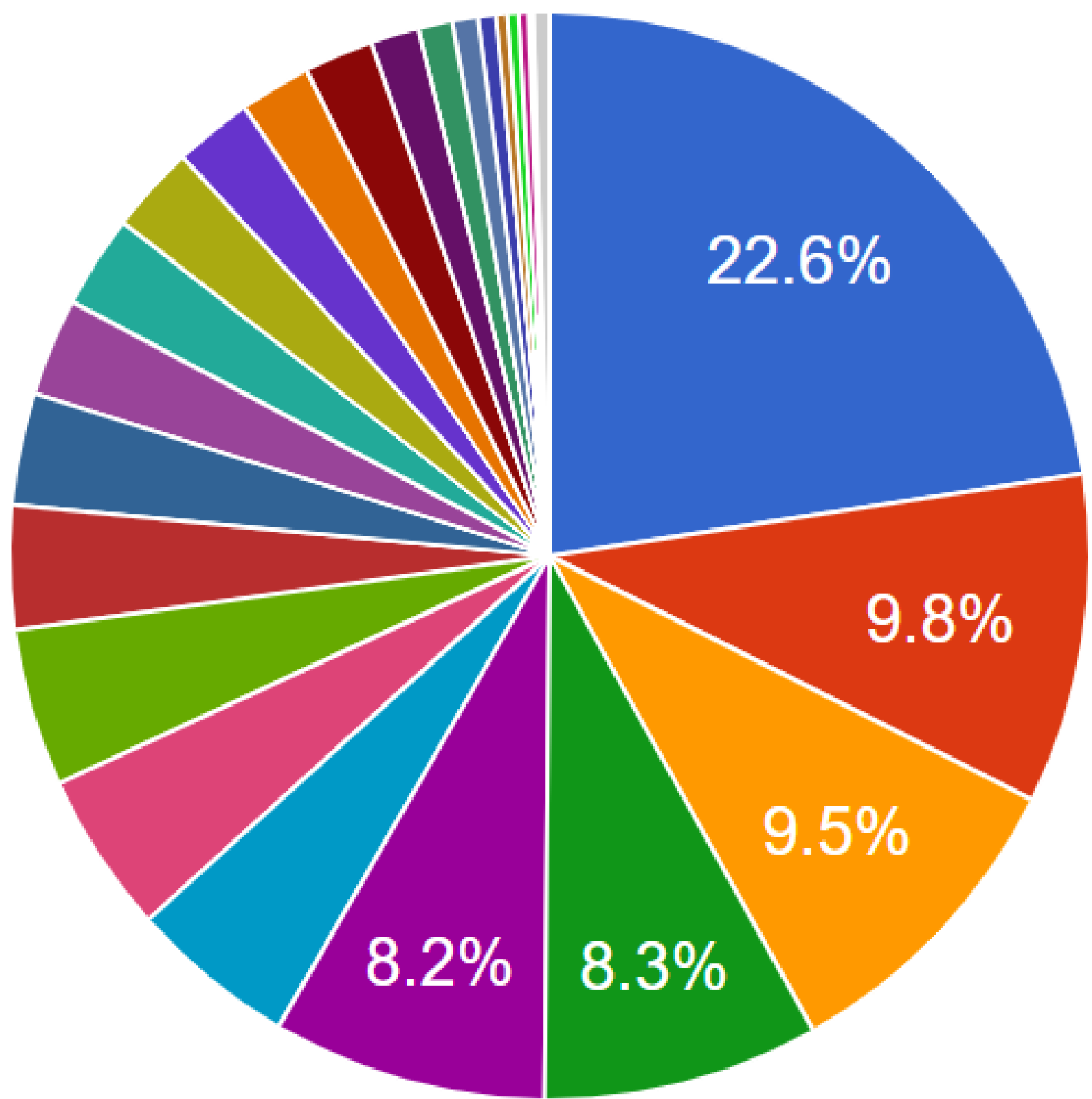

- Parking Lot
  - Classroom
  - Beside Building
  - Hallway
  - Front of School
  - Football Field/Track
  - School Bus
  - Outside on School Property
  - Inside School Building
- ▲ 1/3 ▼

Figure 11. Percentage of students ages 12–18 who reported being afraid of attack or harm during the school year, and percentage who reported avoiding one or more places in school because of fear of attack or harm during the school year: 2019

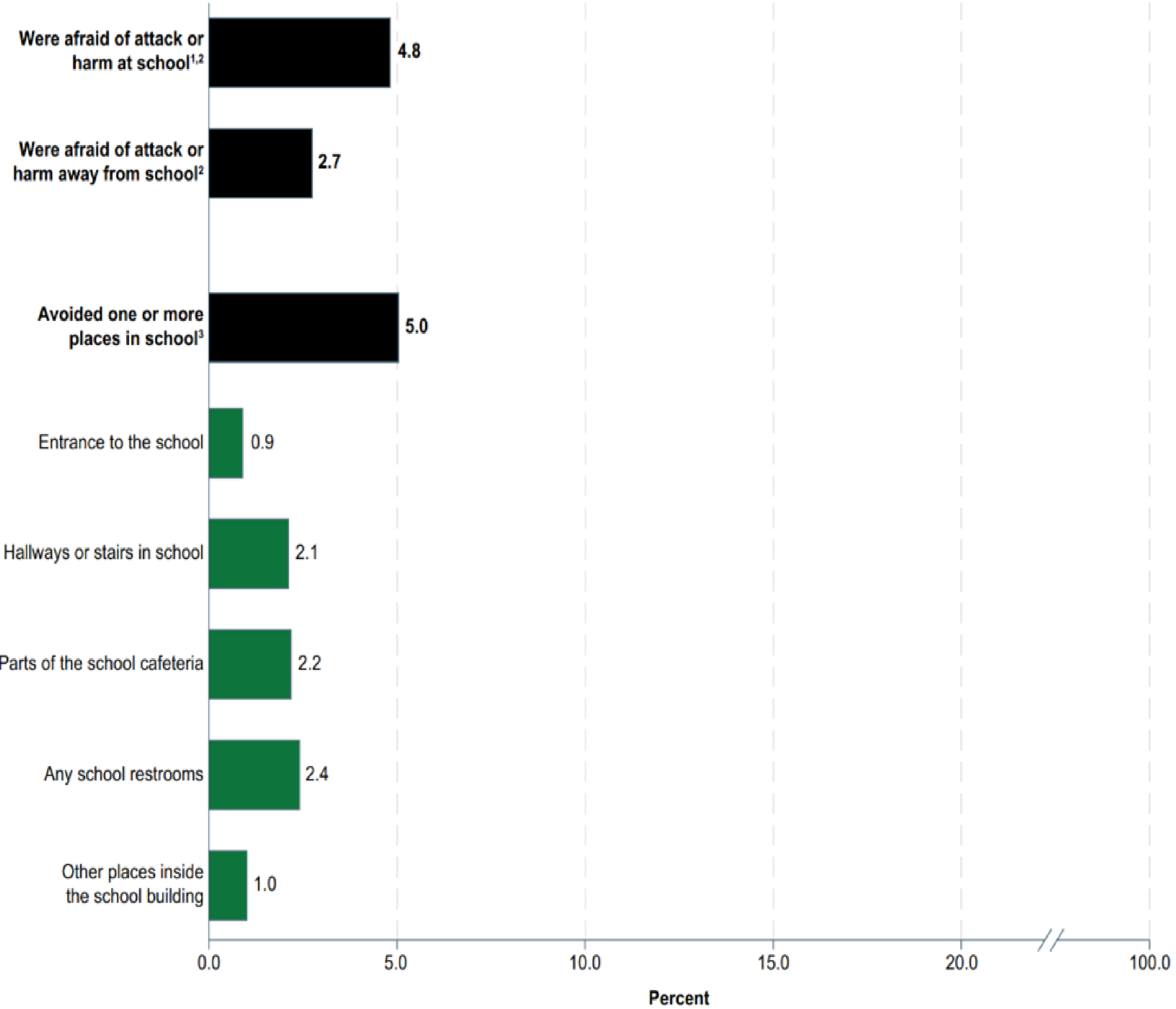

<sup>1</sup> "At school" includes in the school building, on school property, on a school bus, and going to and from school.  
<sup>2</sup> Students were asked if they were "never," "almost never," "sometimes," or "most of the time" afraid that someone would attack or harm them at school or away from school. Students responding "sometimes" or "most of the time" were considered afraid.  
<sup>3</sup> Students who reported avoiding multiple places in school were counted only once in the total for students avoiding one or more places.  
SOURCE: U.S. Department of Justice, Bureau of Justice Statistics, School Crime Supplement (SCS) to the National Crime Victimization Survey, 2019. See *Digest of Education Statistics 2020*, tables 230.70 and 230.80.

# Student Mental Health

Report from the US Department of Justice, Bureau of Justice Statistics, 2019:

- 5% of students ages 12-18 reported being afraid of attack or harm at school
- Only 3% reported being afraid of attack or harm away from school



# School Safety & Mental Health Resources

There continues to be legislative action & funding available at the state level to strengthen both school safety measures and the mental health of our children.

Be proactive with the policies and funding available within your communities.

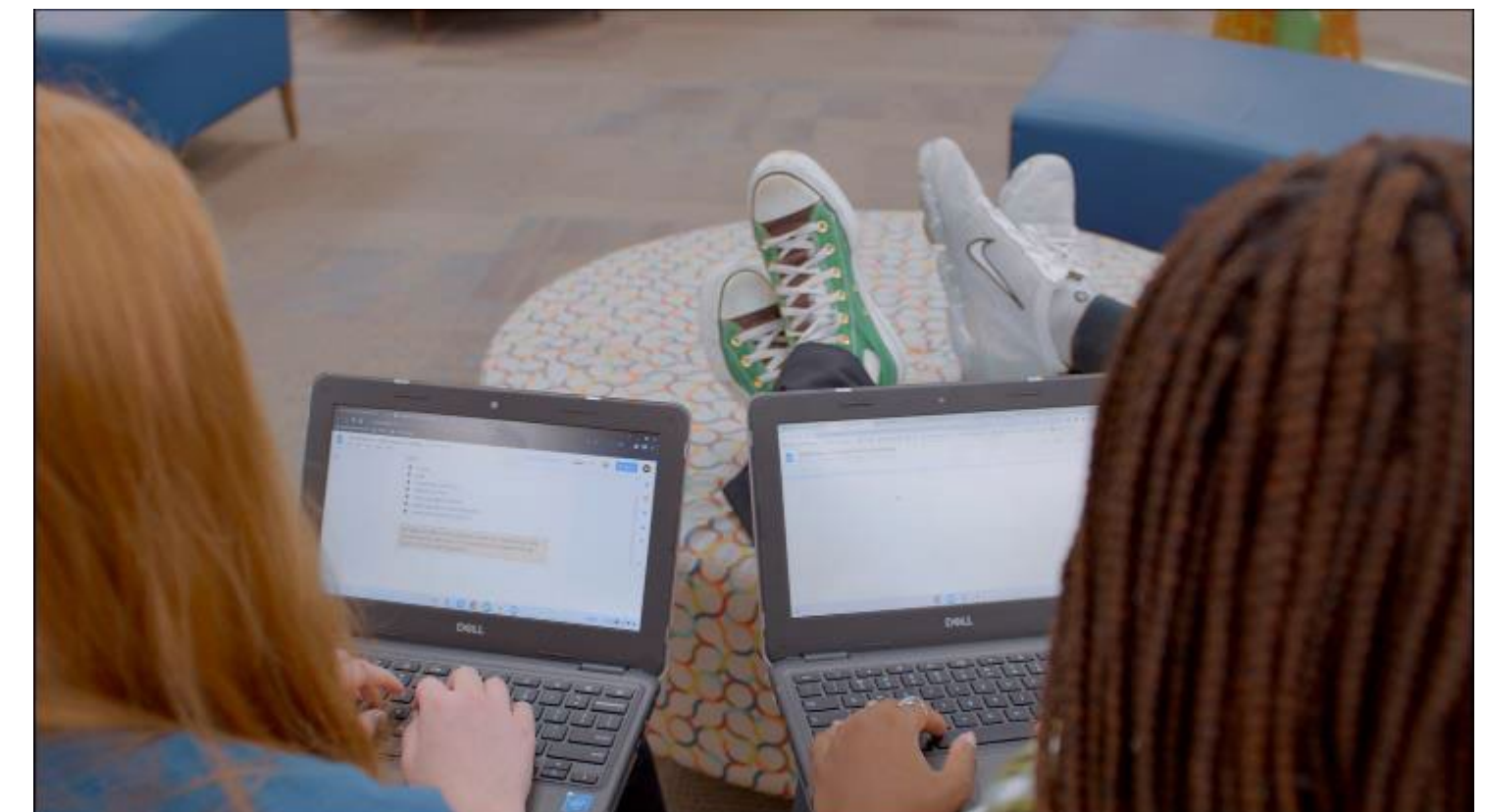



# Site Assessments

---



# Our Approach

A Proven Process

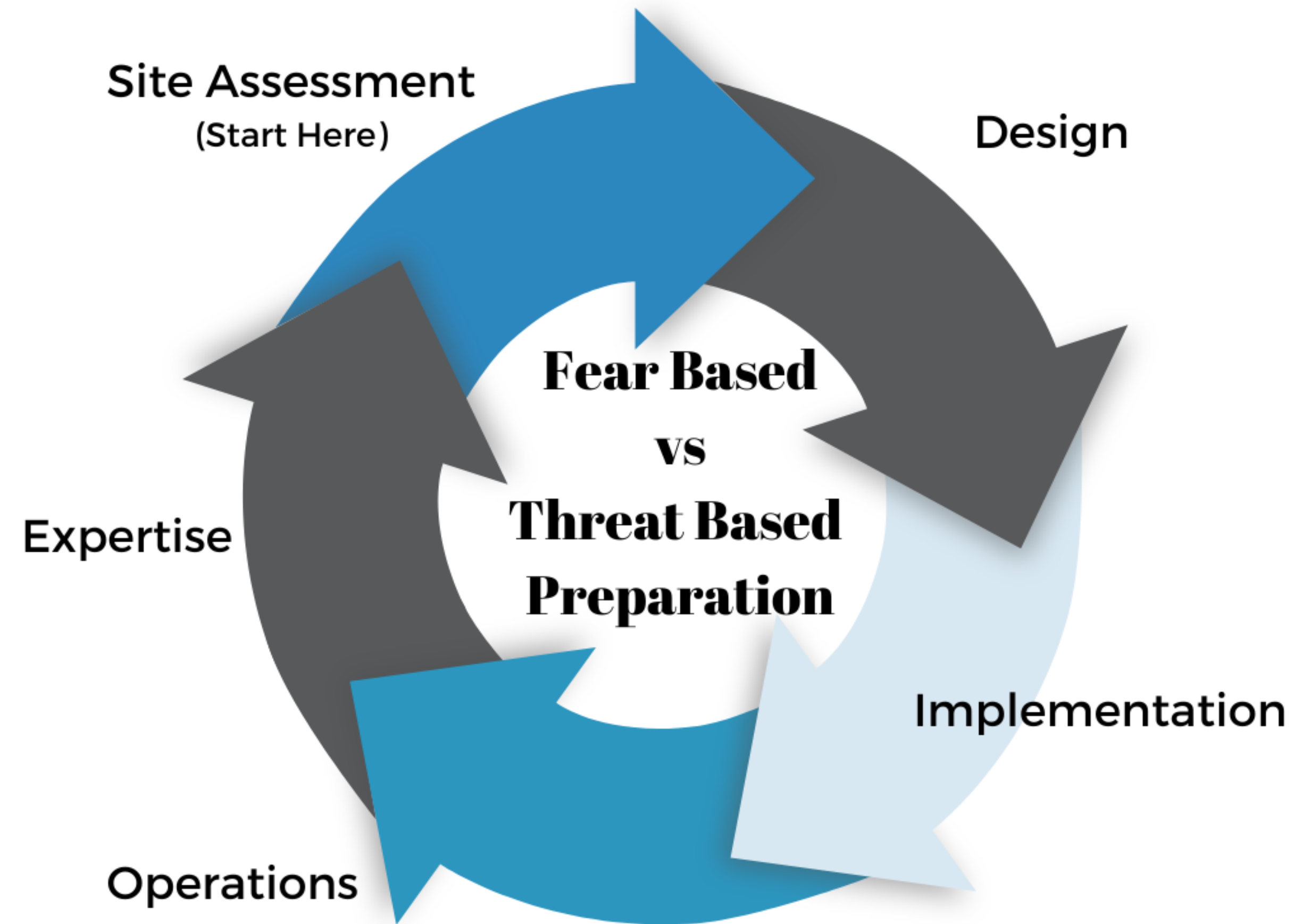

# What Do We Assess?

6 Factors

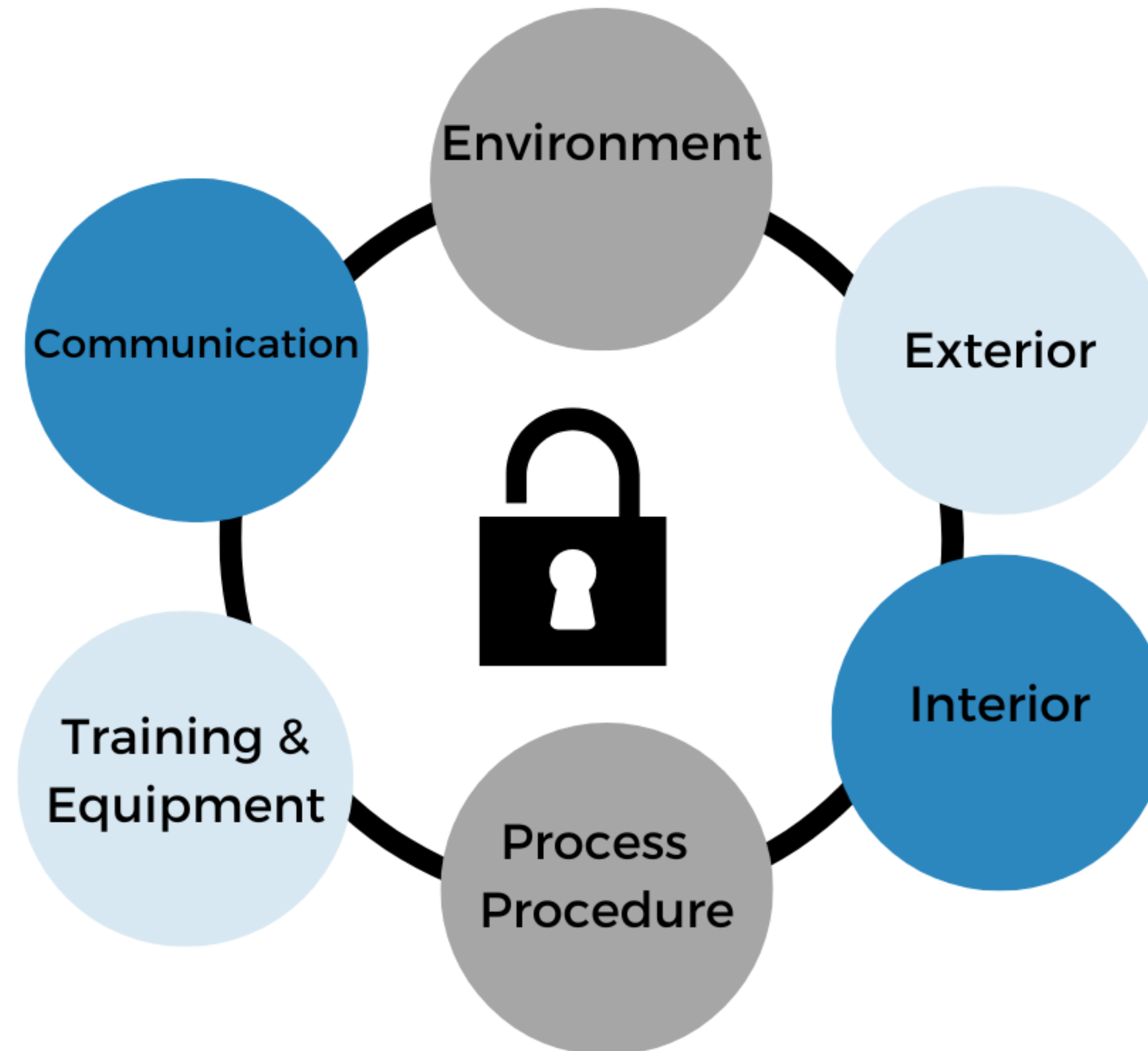



# A Layered Approach to Safety

Not One Without The Other

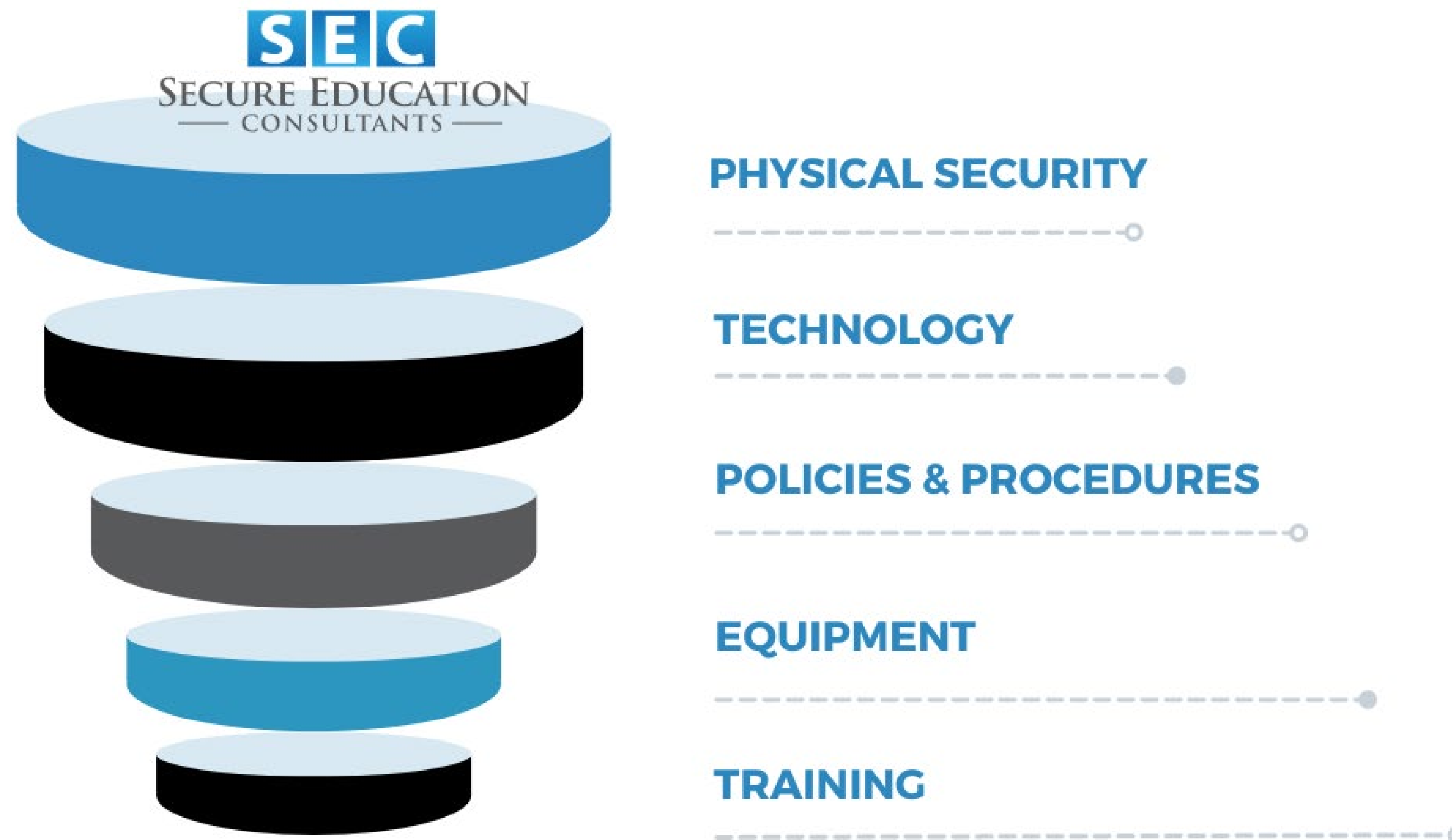

# Design Approach

---



# Keys to Design

An Integrated Approach

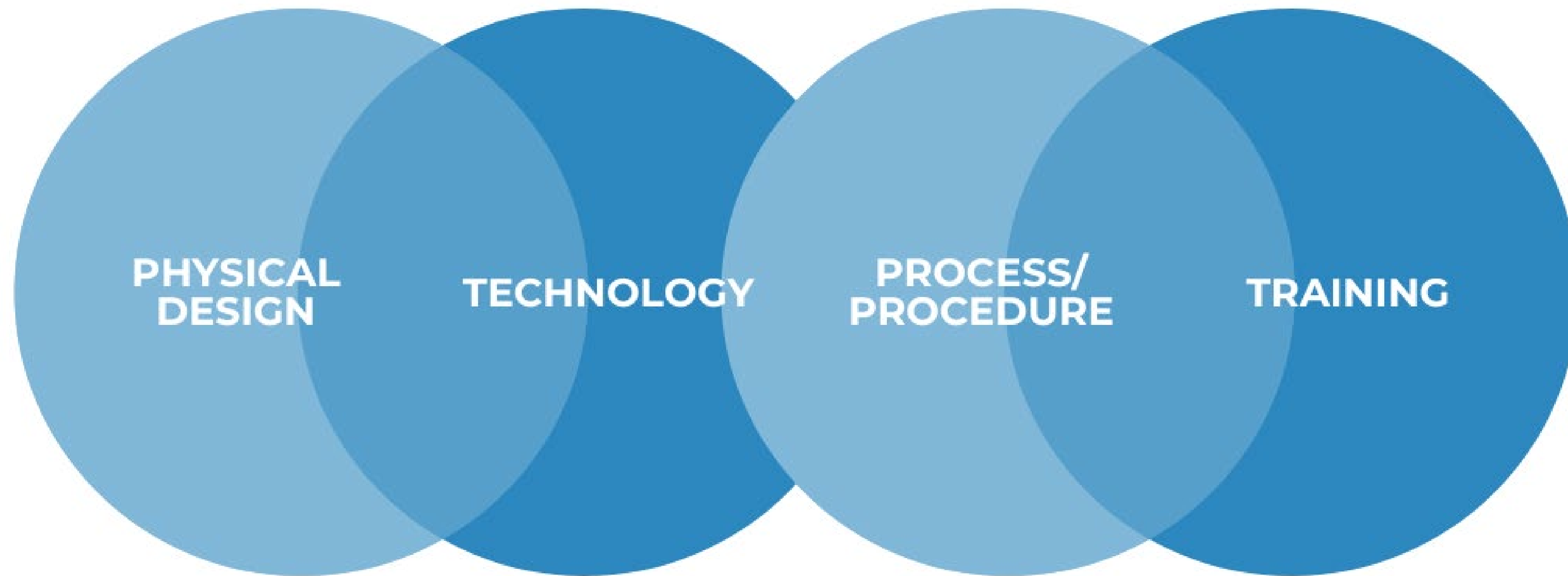



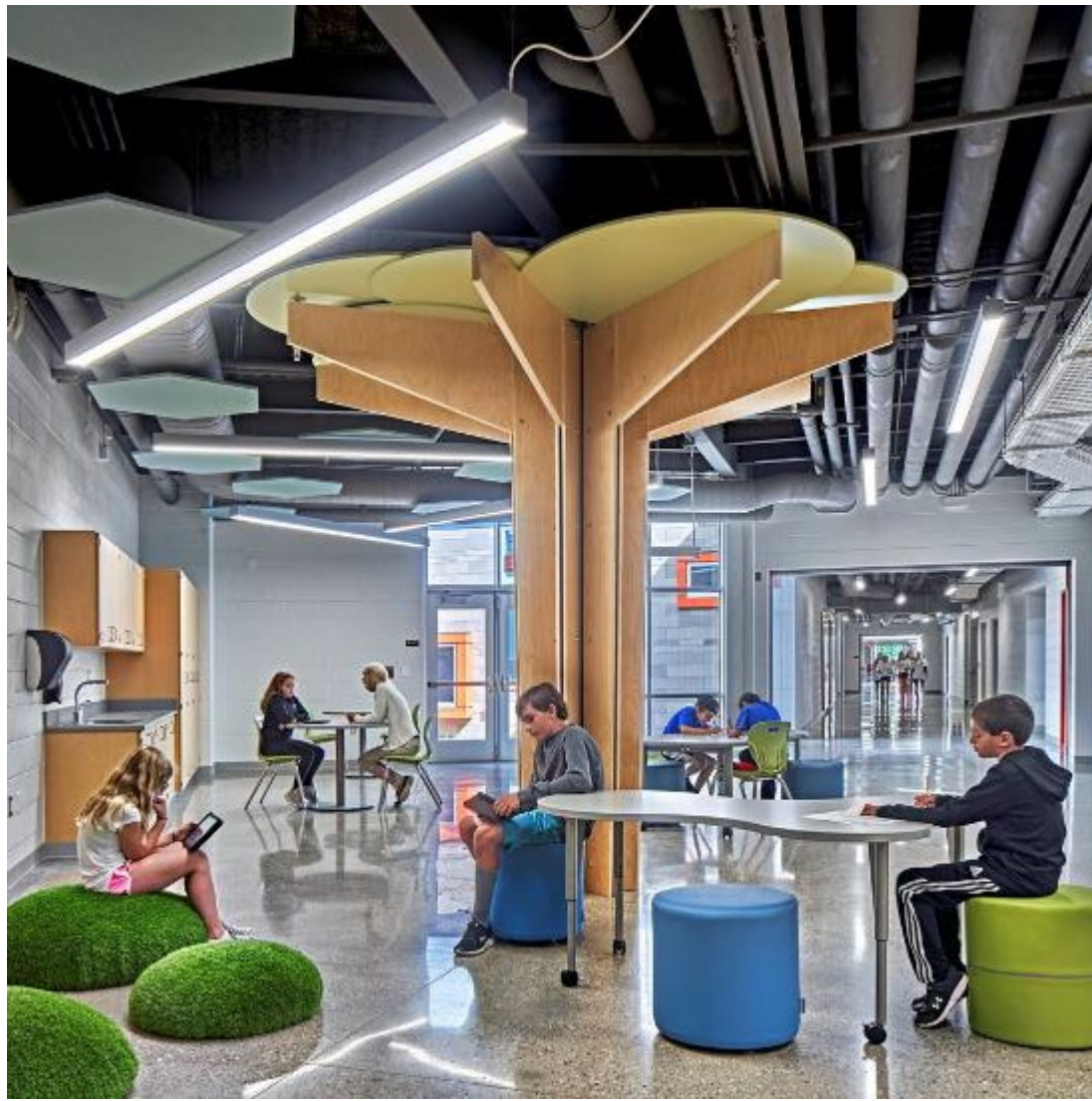

# Student Emotional Well-Being

- Spaces designed with size-appropriate and comforting features
- Colors, patterns, fabric that improve focus and learning
- Utilize daylight and connection to nature

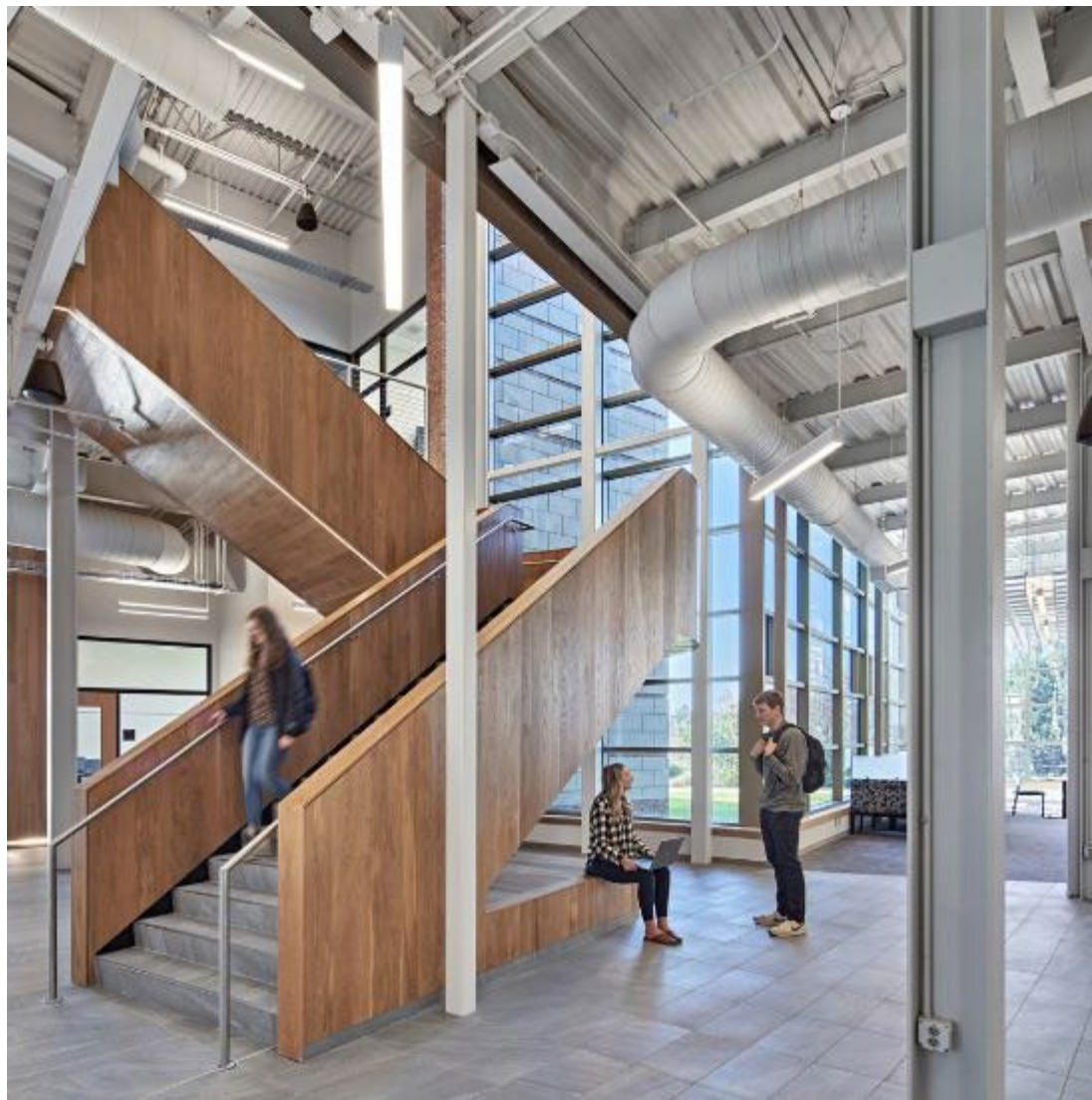





# Teacher Well-Being

Key findings from a 2021 study by the RAND Corporation found that teachers are:

- 2x as likely to experience frequent job-related stress
- Half of teachers reported feeling burned out
- 27 percent said they experience symptoms of depression
- Nearly 1 in 4 teachers said they were likely to leave their current teaching jobs by the end of this school year



# Mental Health

- Student mental health
- Teacher mental health and burnout (leading to teacher shortages)
- Health protocols (COVID-19)





# Flexible Design

Flexibility in design will help support changing security protocols and best practices.

- Review with local law enforcement (SRO)
- Crime Prevention Through Environmental Design (CPTED)
- Design should inspire and facilitate learning while supporting safety







# Secure Entrances

Why Do We Have Them?



SECURE EDUCATION  
CONSULTANTS





# Welcoming Entrances

How to Maximize Security and Reduce Cost







# Locker Commons

---

- Allows for passive supervision of students
- Center of school community
- Creates cover for first responders





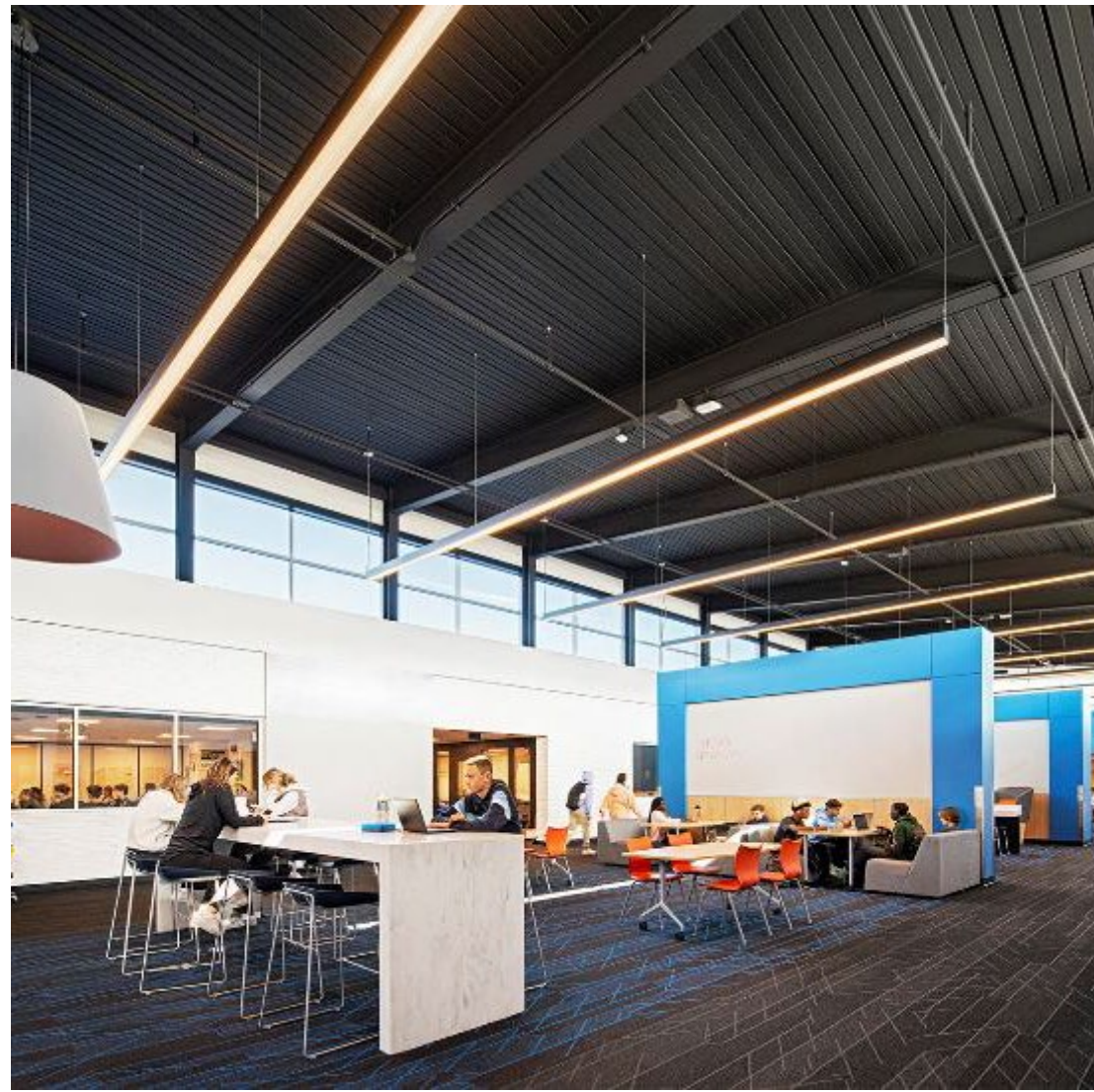

# Learning Communities

- Project-Based Learning
- Extended Learning Areas
- Breakout Spaces
- Outdoor Learning





# Active Shooter Response



Secure



Escape



Confront





# Secure + Shelter in Place

- Visibility through entrance for supervision of students
- Wing walls facilitate shelter-in-place opportunity





# Doors + Locks

---

- Use film or design strategies to protect interior door handles
- Door lock types
- Door barricade devices







# Incident Command Center

---

**Identify a Command Center in the Emergency Action Plan.**

- Conference Room with privacy
- Internet capability
- Telephone and Cell Phone Service
- Building Maps Available
- Building master keys and card keys
- Communication for meetings with multiple agencies





## Site Design

---

- Protect glass entries from vehicles
  - Plantings, benches, building structure, concrete base, bollards
- Outside Door Numbering with key placard
  - Made a huge difference in shooting in Oxford, MI
  - Mirror these numbers on the inside of exterior doors or place numbers on glass for wayfinding - “Victims coming out of door 4,” for example



# Key Takeaways

- Partnering with a security consultant in projects is critical in the design phase.
- Site Assessments can help fund future projects.
- Design for flexibility can support changing security protocols.
- Practice drills with compartmentalization doors closed.
- Security looks different for every project and building. One size does not fit all.
- Design secure environments for working & learning, not a prison with books in it.





# Questions?

---



# Thank You!

EdSpaces

Please scan the QR code to  
provide session feedback

