

DLRGROUP

ED SPACES 2022: CLASSROOM DESIGN

Based on best practices, we will provide a variety of seating that is both traditional and non-traditional. Traditional options include items such as standard student chairs or mobile seats with tablets. Non-traditional options are movement / wobble stools, grassy domes and soft seating.

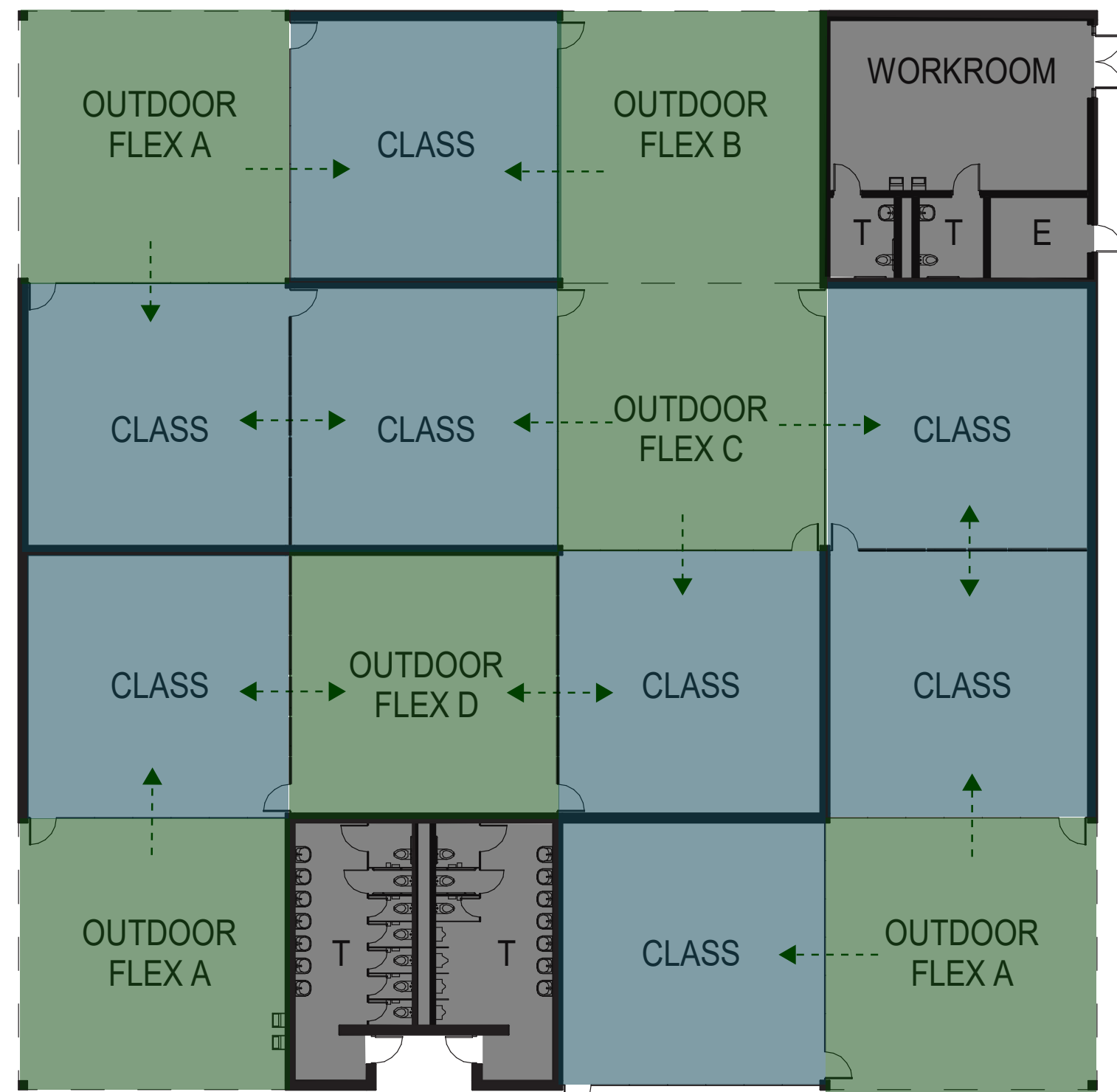
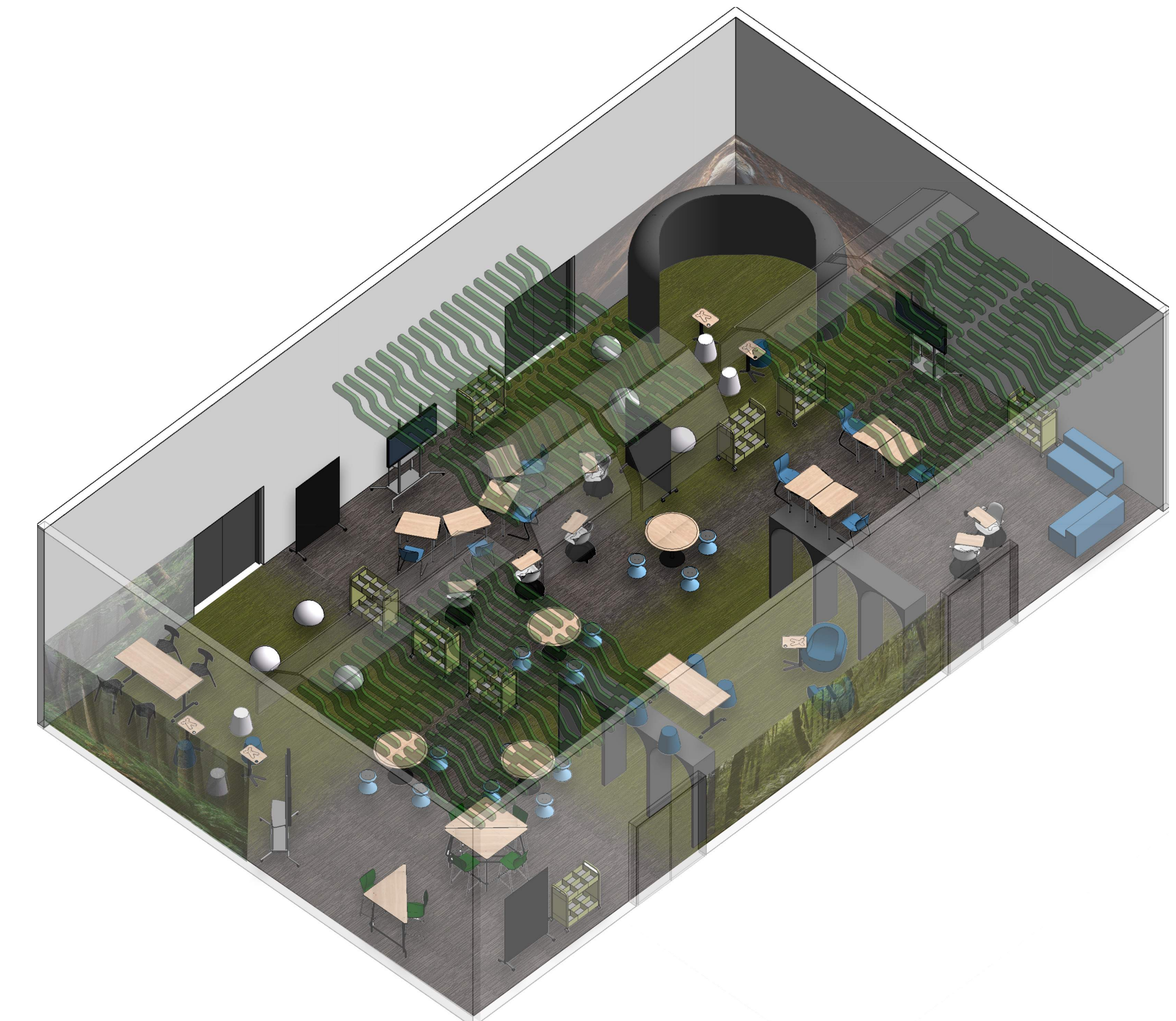

DIAGRAM A

CONCEPT IMAGERY



The connection between the natural environment and the building interior is identified with open “garage doors” created with acoustic panels, and with an interior acoustic ceiling mimicking the colors and forms found in nature. Walls are implied with mobile elements like screens and markerboards, as well as technology for learning environments. Acoustic elements are also utilized to define space along an arched portico “window”, and through a cave-like learning nook for someone to experience a sense of embraced safety in the expansive outdoors. Visually, we embraced the Oregon forests and selected materials and graphics that encourage a calm and engaging learning environment.

